

| Path No<br>[Council-Parish-<br>Path No] | PARISH                           | START                                                | FINISH                                                    |
|-----------------------------------------|----------------------------------|------------------------------------------------------|-----------------------------------------------------------|
| <b>3-39-FP21</b>                        | <b>Sawley<br/>Ribbles Valley</b> | <b>Track &amp; Sheep Pens below<br/>Cowgill Farm</b> | <b>Junction with path 3-39-<br/>FP14 near stile 14.S2</b> |
| START MAP REF                           | SD 8008 4657                     | FINISH MAP REF                                       | SD 7954 4654                                              |

Date: 12 July 2015

Surveyed by: Richard Sherras (+Billy &amp; Bertie)

Revision No 0

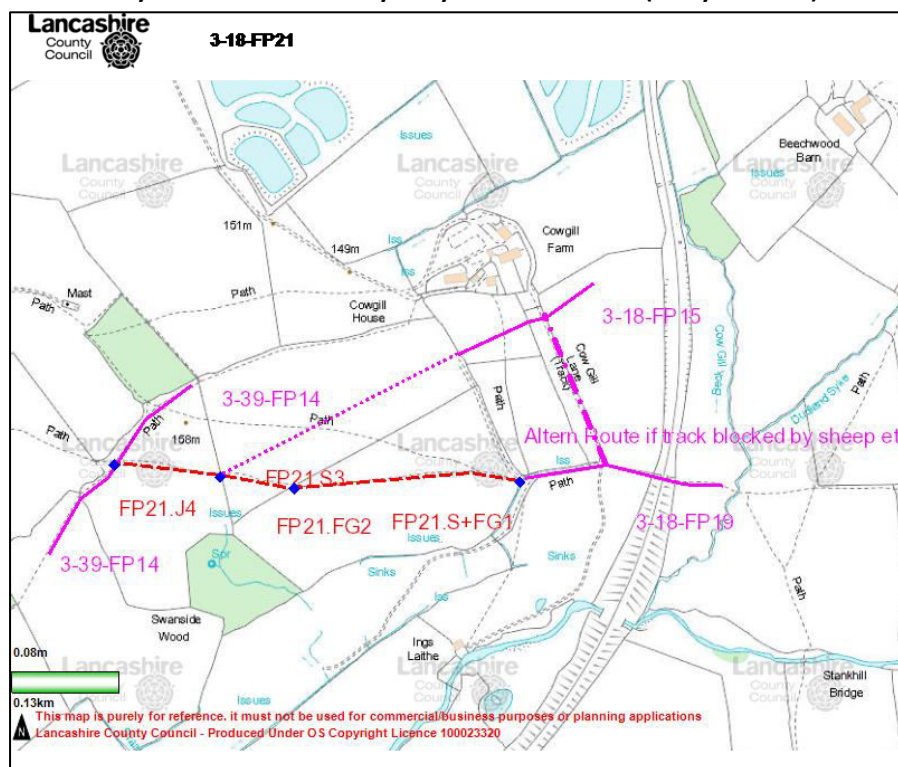

### +++IMPORTANT NOTICE+++





The line of the footpath(s) on the maps & directions in the text are intended only as an indication of the route. They should not be taken as showing the exact position of the legal right of way of the Path on the Local Authority Definitive Map. Features (stiles, footbridges, etc) may have been moved off the exact definitive path location by the landowner (farmer, occupier, etc) for operational efficiency, to avoid natural hazards eg land erosion or simply for user convenience. Relocation by owners can be deemed as implicit permission to deviate from the definitive path without trespassing but this does not establish a change to a legal right of way.

| Feature Number<br>[Key at Foot<br>of Page] | Feature &<br>Map Ref                         | Path Description & Photo(s)                                                                                                                                                                                                                                                                                                                                                                                                                                                                                                                                        |
|--------------------------------------------|----------------------------------------------|--------------------------------------------------------------------------------------------------------------------------------------------------------------------------------------------------------------------------------------------------------------------------------------------------------------------------------------------------------------------------------------------------------------------------------------------------------------------------------------------------------------------------------------------------------------------|
| 21.FG1                                     | Field Gate<br>+ Stile<br><br>SD<br>8008 4657 | <p>The stretch of the track between the gates 19.FG1 &amp; 19.FG2 is used by the farmer for sorting/shearing, etc sheep so getting to start FG1 on Path 3-39-FP21 is not always very practical. An alternative is to take the track shown on map as "Altern Route, etc". Go up track to stile 3-18-FP15.S7 then ladder stile 3-18-FP15.S8. From ladder stile follow dotted line to FP21.S3 -see map NB The track is not a definitive path so is not a public right of way</p>  |

FG=Field gate,  
BB=Bridlewaybridge,  
BG=Bridlewaygate,  
CG=Cattle grid,

F=Ford/Ditch crossing,  
FB=Footbridge  
HR=Hand rail  
KG=Kissing gate

LS=Ladder stile  
S=Stile  
SP=Stepping stones  
WG=Wicket/Pedestrian gate

|        |                                                                            |                                                                                                                                                                                                                                                                                                                                                                                                                           |
|--------|----------------------------------------------------------------------------|---------------------------------------------------------------------------------------------------------------------------------------------------------------------------------------------------------------------------------------------------------------------------------------------------------------------------------------------------------------------------------------------------------------------------|
| 21.FG2 | Field Gate<br><br>SD<br>7980 4655                                          | From 21.S+FG1 go diagonally uphill roughly towards middle of top boundary & trees. Photo taken looking back towards 21.S1 – note pile of compost in this (centre left) & previous photo<br>                                                                                                                                             |
| 21.S3  | Stile<br>Stepover<br><br>SD<br>7971 4657                                   | From gate 21.FG2 carry on diagonally across - Stile S3 is in fence<br>                                                                                                                                                                             |
| 21.J4  | Junction<br>+ Farm Gate<br>& Stile 3-39-<br>FP14.S2<br><br>SD<br>7954 4654 | Continue diagonally towards far left hand corner of field to join path 3-39-FP14 & reach stile 3-39-FP14.S2 – see map<br> <br>Path 3-39-FP21 continues to A59 near New Sawley Grange Farm but not surveyed beyond junction (21.J4) with 3-39-FP14. |

**Disclaimer:** This document has been produced on an unpaid voluntary basis for the information of parish residents & visitors. It shows pictures & description of routes as at the survey/revision date on this report changes may have occurred since that date. The author has no responsibility for the paths and no liability is taken for any inaccuracies in this document, nor for subsequent changes to or damage or injury when using a path or any other matter. The document can be used freely for non-commercial purposes provided due respect is maintained for map copyright & that an acknowledgement of the author is included.

© Richard Sherras, September 2016

FG=Field gate,  
BB=Bridlewaybridge,  
BG=Bridlewaygate,  
CG=Cattle grid,

F=Ford/Ditch crossing,  
FB=Footbridge  
HR=Hand rail  
KG=Kissing gate

LS=Ladder stile  
S=Stile  
SP=Stepping stones  
WG=Wicket/Pedestrian gate