

PLAN OF RIMINGTON MOOR 4th Nov 1834

Key

AAA Line marked out by T Kell for walling

a John Dean corner Mere Stone

b & c two Mere Stones were grown over with Ling (common heather) (c is below left of top A)

d end of old Ditch

e the Mere Stone Henry Hall spoke of at Rimington. Described on the original plan by Mr Kell as having the appearance of a Boundary Stone. (e is at 10 o'clock to b)

y Freeholders 1834 area (grey) 27A 0R 0P

z Geo. Lane Fox Esqr 1834 area 132A 3R 33P

Scale of the plan is in chains but it is wrong. The figures are half what they should read. And the north direction mark is pointing in the wrong direction.

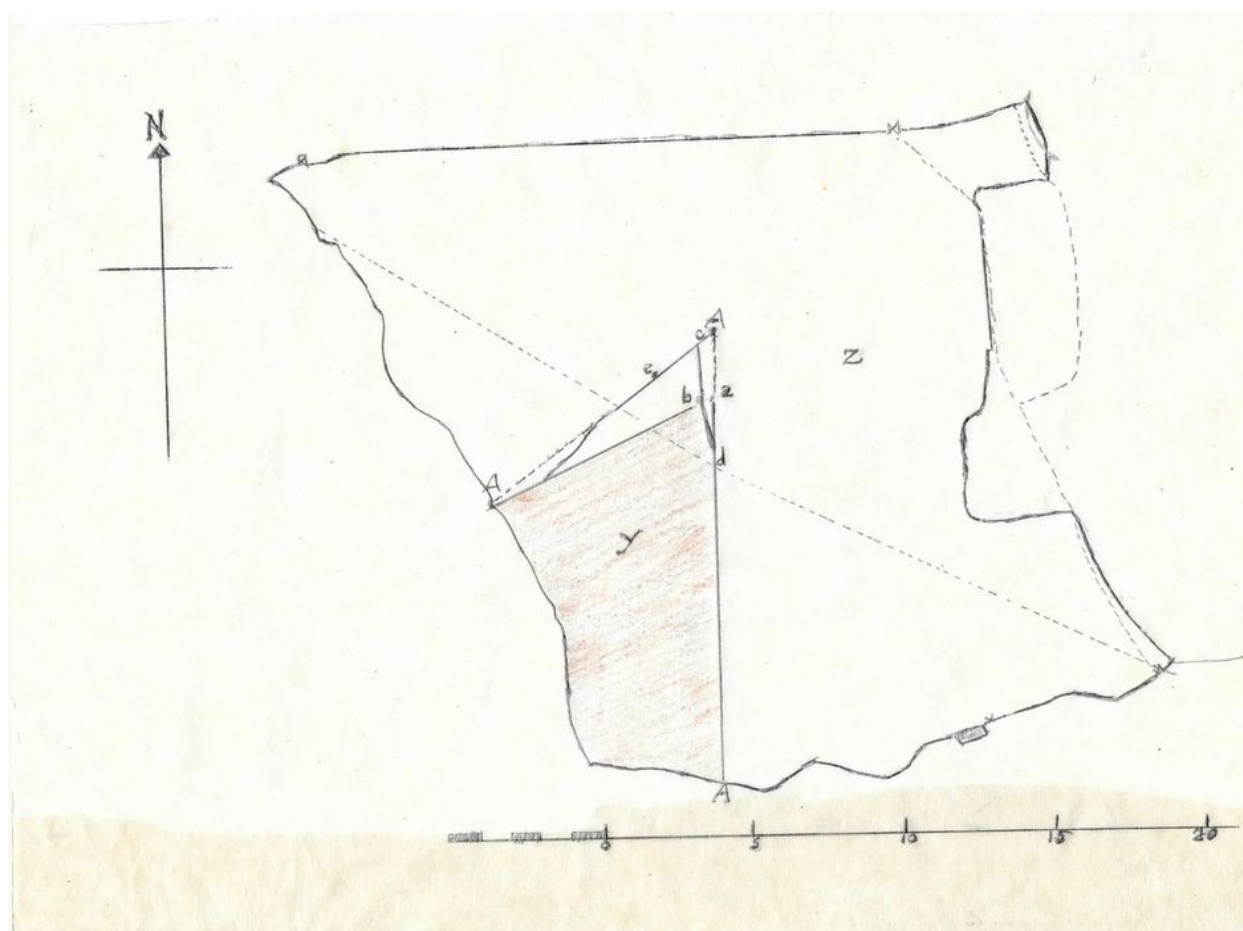

Photographs of the former boundary wall and gateway on Rimington Moor. The wall separated the grazing areas of the Freeholders and George Lane Fox Esqr's tenants. The freeholders land is to the left of the wall on these pictures. The gateway is only a few yards south of the northern most 'A' marked on the plan.

