

Path No [Council-Parish- Path No]	PARISH	START	FINISH
<b>3-18-FP18</b>	<b>Gisburn Ribble Valley</b>	<b>Stile at Junction with FP3-36-13 at Stile 3-36- FP13.S5 Rim'ton Boundary</b>	<b>Great Dudlands at Junction with 3-18-FP13 at Stile 3-18-FP13.S7</b>
START MAP REF	SD 8116 4682	FINISH MAP REF	SD 8049 4707

Date: 14 Feb 2015

Surveyed by: Richard Sherras (+Billy &amp; Bertie)

Revision No 0

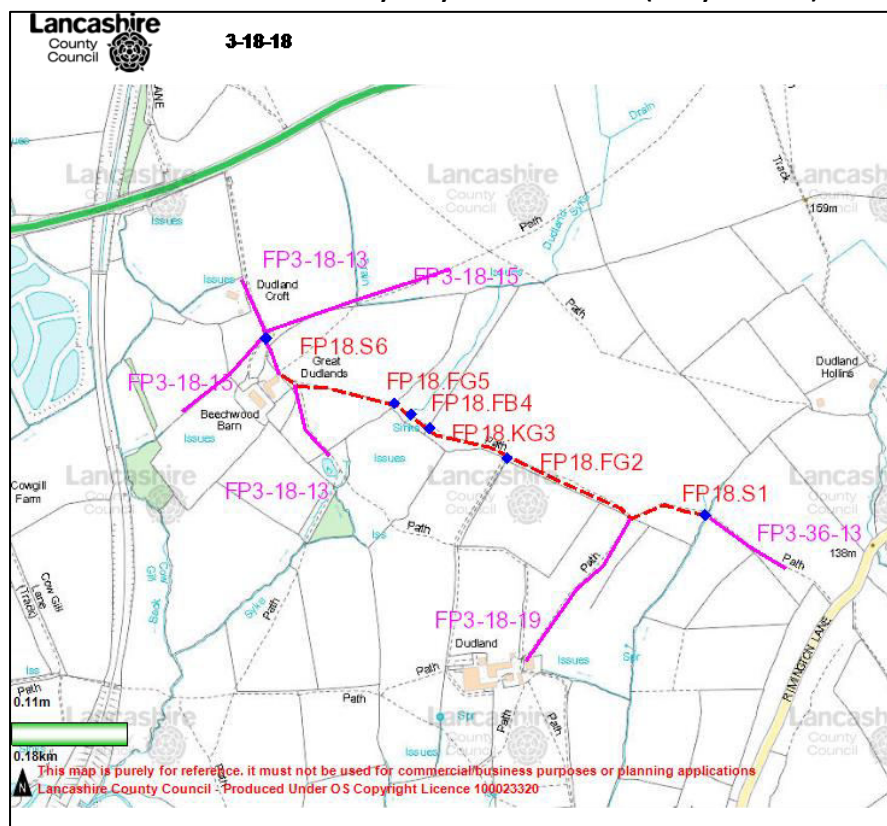

### +++IMPORTANT NOTICE+++

The line of the footpath(s) on the maps & directions in the text are intended only as an indication of the route. They should not be taken as showing the exact position of the legal right of way of the Path on the Local Authority Definitive Map.





Features (stiles, footbridges, etc) may have been moved off the exact definitive path location by the landowner (farmer, occupier, etc) for operational efficiency, to avoid natural hazards eg land erosion or simply for user convenience. Relocation by owners can be deemed as implicit permission to deviate from the definitive path without trespassing but this does not establish a change to a legal right of way.

Feature Number [Key at Foot of Page]	Feature & Map Ref	Path Description & Photo(s)
18.S1	Stile Cross Step + Ditch  SD 8116 4682	Stile & ditch at end of 3-36-FP13 Rimington/Gisburn boundary  

FG=Field gate,  
BB=Bridlewaybridge,  
BG=Bridlewaygate,  
CG=Cattle grid,

F=Ford/Ditch crossing,  
FB=Footbridge  
HR=Hand rail  
KG=Kissing gate

LS=Ladder stile  
S=Stile  
SP=Stepping stones  
WG=Wicket/Pedestrian gate

18.FG2	Field Gate  SD 8085 4690	Head alongside with hedge on left till Gateway 
18.KG3	Kissing Gate  SD 8073 4695	After gateway FG2 keep straight ahead keeping fence/hedge to left. Ignore Field Gate on left – Kissing Gate ahead & slightly right by twisted thorn tree  
18.FB4	Footbridge Drainpipe  SD 8070 4697	A large drainpipe forms a footbridge over the ditch. Head for field gate on opposite side 
18.FG5	Field Gate Standard  SD 8068 4698	

FG=Field gate,  
BB=Bridlewaybridge,  
BG=Bridlewaygate,  
CG=Cattle grid,

F=Ford/Ditch crossing,  
FB=Footbridge  
HR=Hand rail  
KG=Kissing gate

LS=Ladder stile  
S=Stile  
SP=Stepping stones  
WG=Wicket/Pedestrian gate

18.S6	Stile Double Step  SD 8049 4707	<p>3-18-FP18 ends at Stile 18.S6 which is junction with Path 3-18-FP13 at Great Dudlands. Do not get confused with start point at Stile 18.S1 which by coincidence is also a junction with a FP13 but is in Rimington Parish (3-36-FP13)</p> <p><i>Ignore gate on left (cannot exit drive) go straight ahead to stile</i></p> 
-------	---	--

**Disclaimer:** This document has been produced on an unpaid voluntary basis for the information of parish residents & visitors. It shows pictures & description of routes as at the survey/revision date on this report changes may have occurred since that date. The author has no responsibility for the paths and no liability is taken for any inaccuracies in this document, nor for subsequent changes to or damage or injury when using, a path or any other matter. The document can be used freely for non-commercial purposes provided due respect is maintained for map copyright & that an acknowledgement of the author is included.

© Richard Sherras, September 2016

FG=Field gate,  
BB=Bridlewaybridge,  
BG=Bridlewaygate,  
CG=Cattle grid,

F=Ford/Ditch crossing,  
FB=Footbridge  
HR=Hand rail  
KG=Kissing gate

LS=Ladder stile  
S=Stile  
SP=Stepping stones  
WG=Wicket/Pedestrian gate